

## **Appendices**

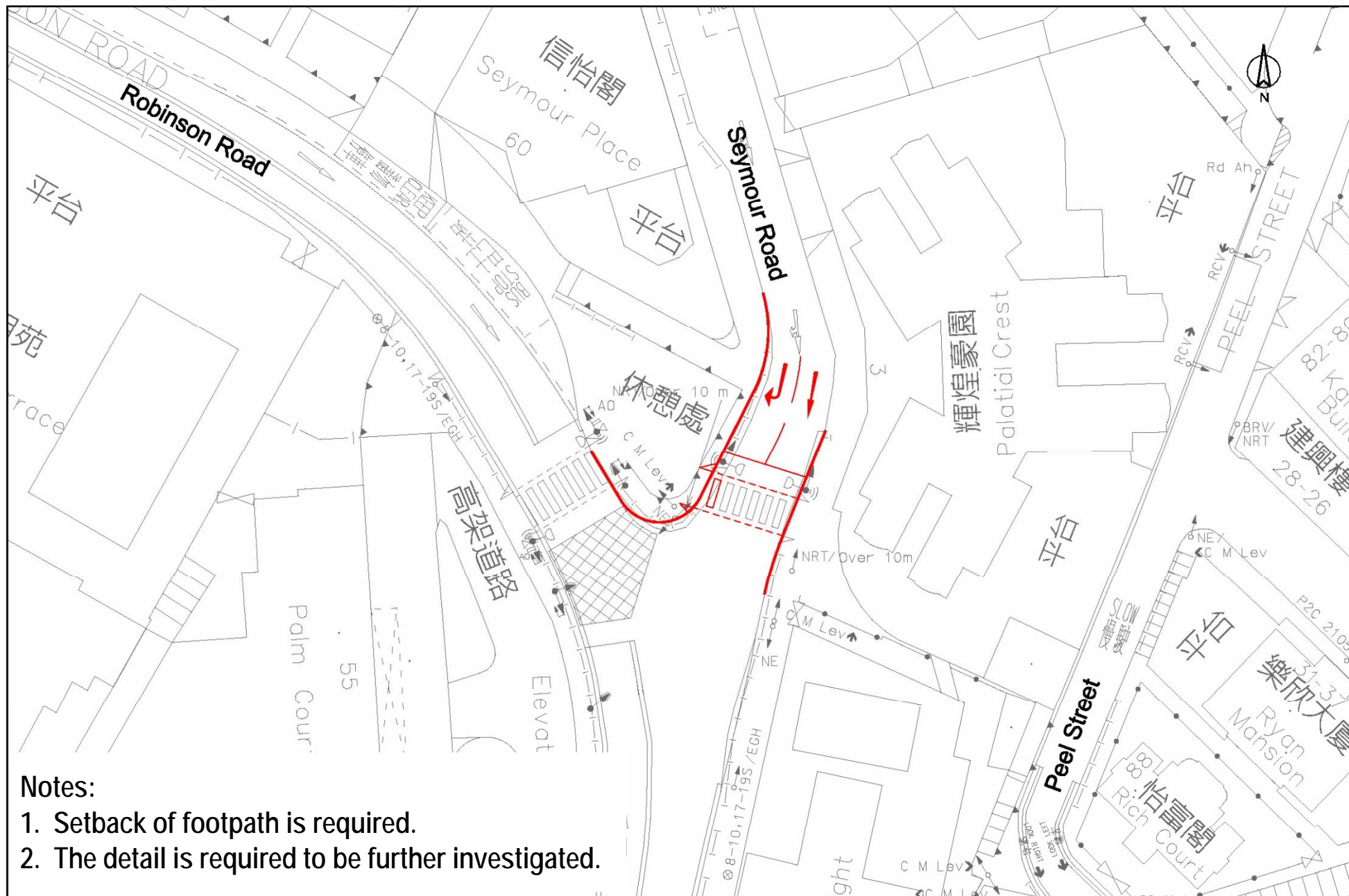

**Appendix A1 : Proposed Improvement Measure at JN7 – Robinson Road/ Seymour Road**

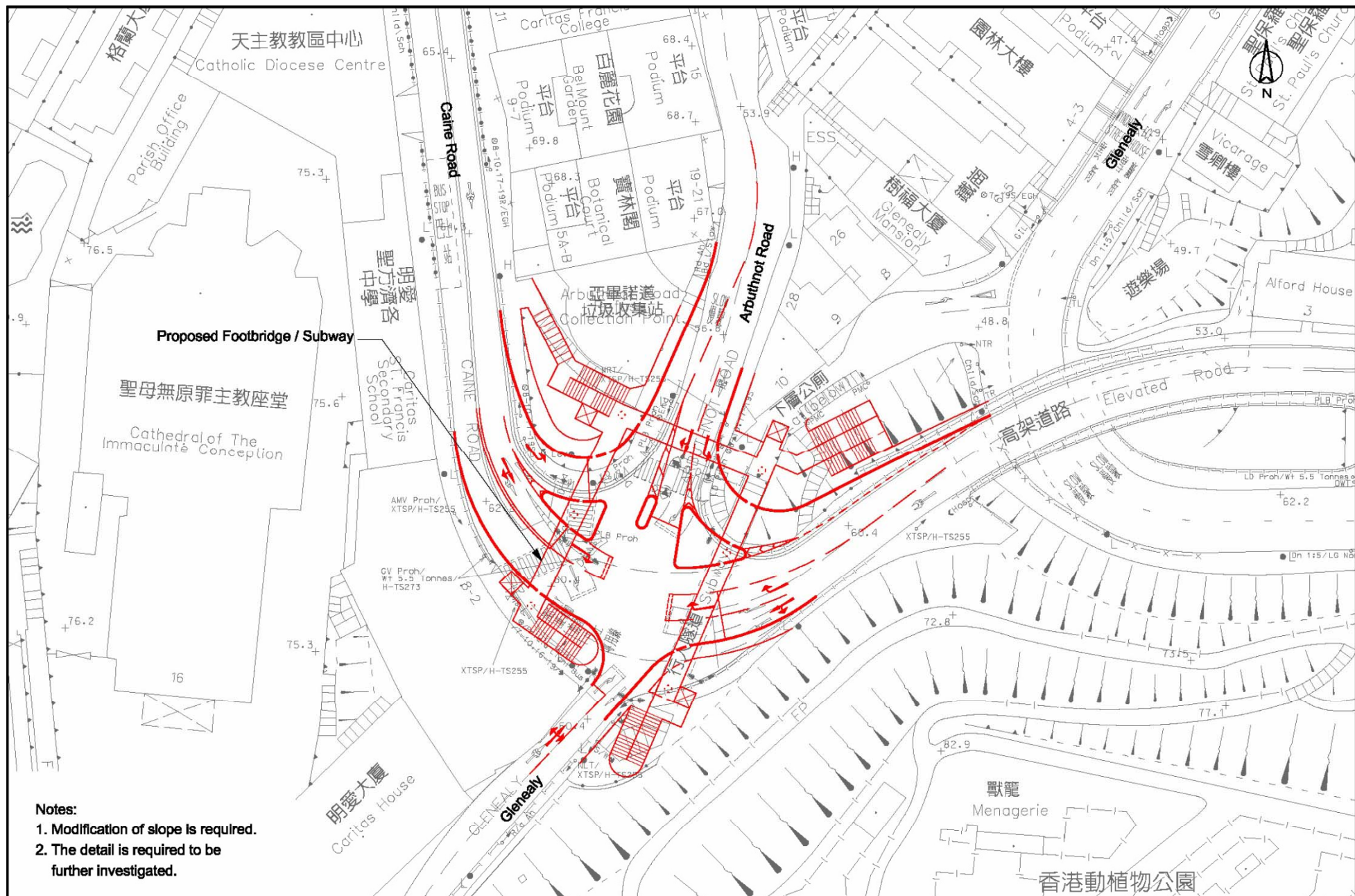

## Appendix A2 : Proposed Improvement Measure at JN9 – Caine Road/ Arbuthnot Road/ Upper Albert Road/ Glenealy



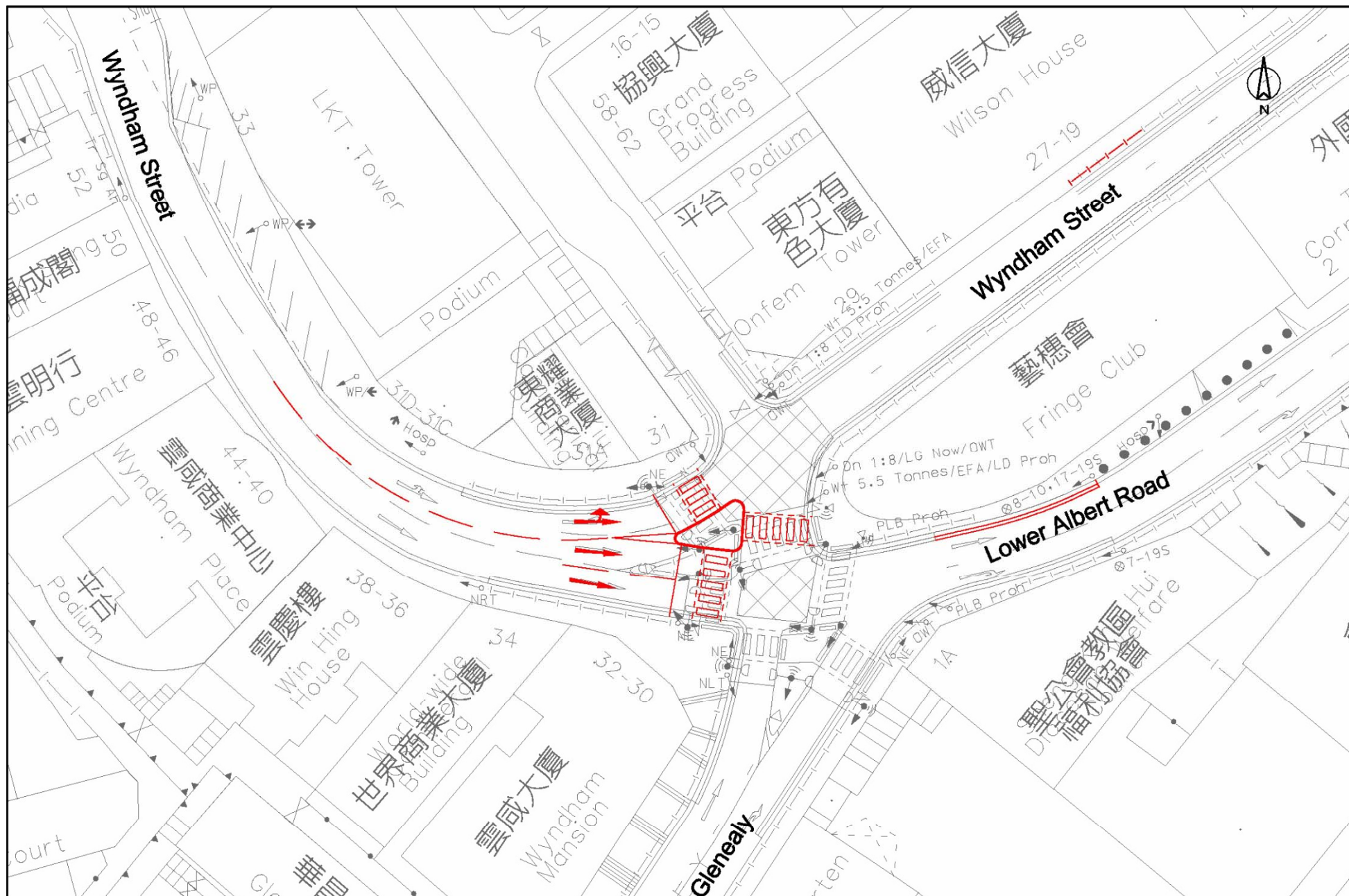

**Appendix A3 : Proposed Improvement Measure at Wyndham Street/ Glenealy/ Lower Albert Road**

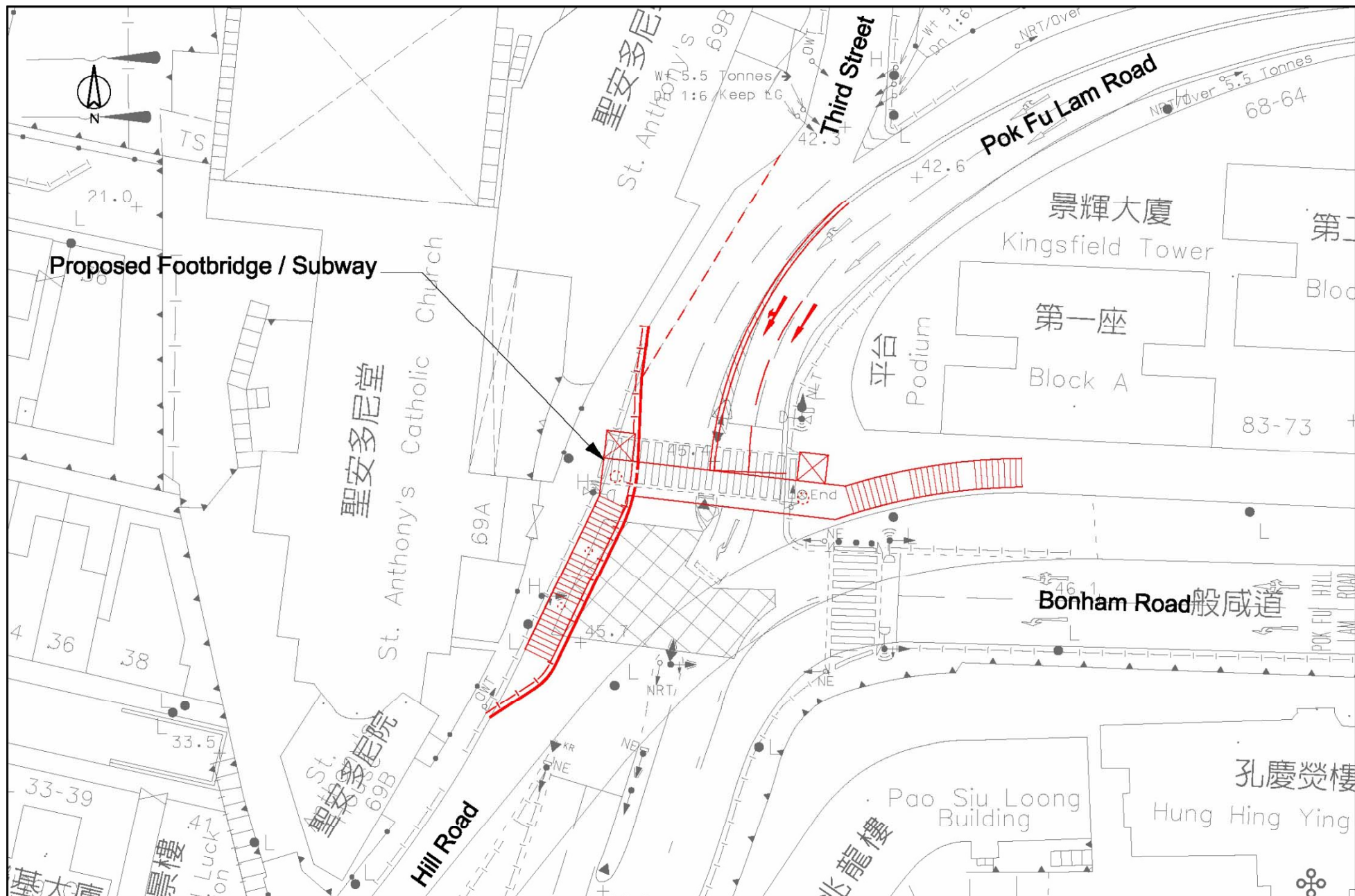

## Appendix A4 : Proposed Improvement Measure at JN1 – Bonham Road/ Pok Fu Lam Road



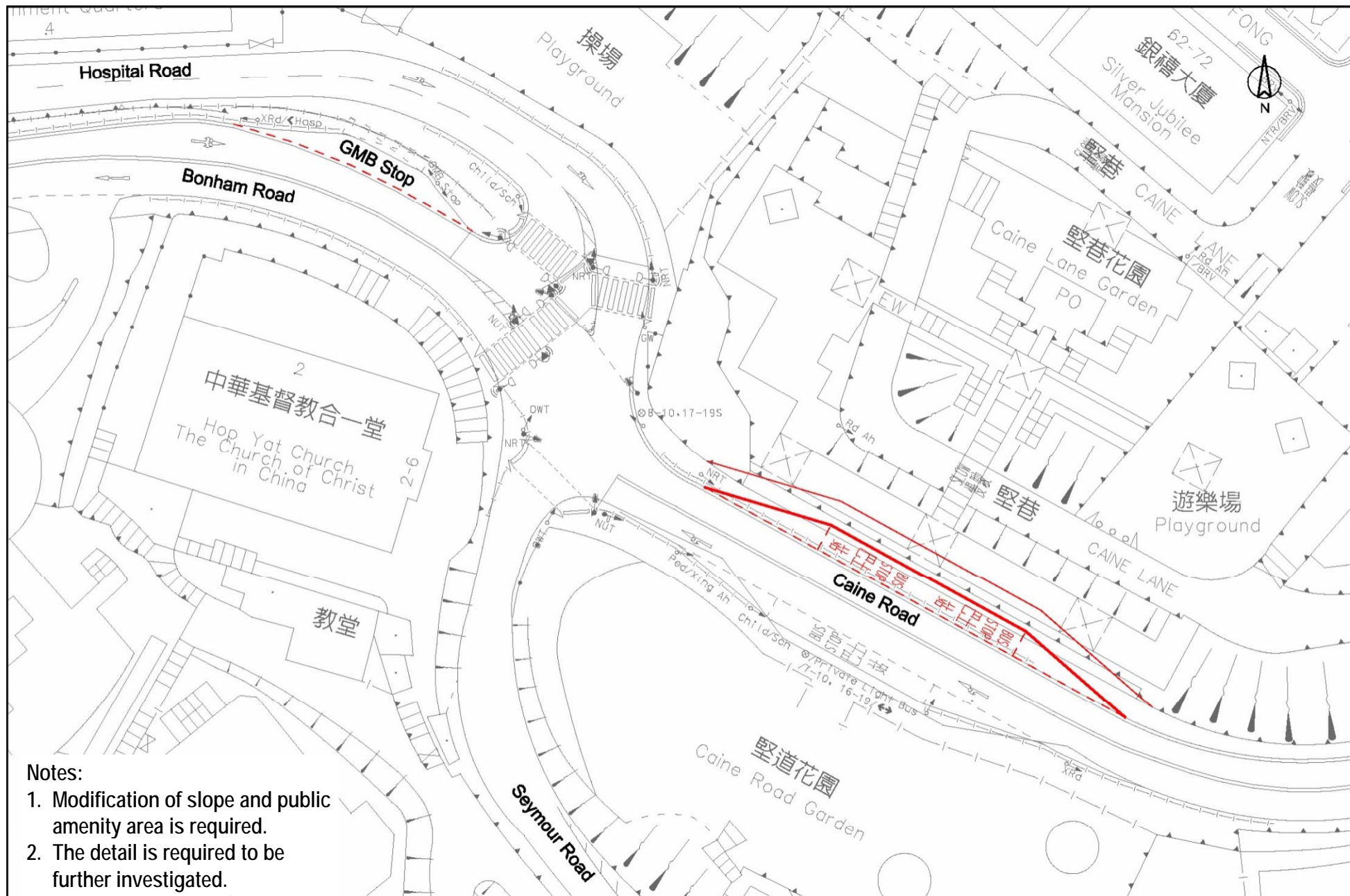

**Appendix A5 : Proposed Improvement Measure at JN6 – Caine Road/ Hospital Road/ Seymour Road**



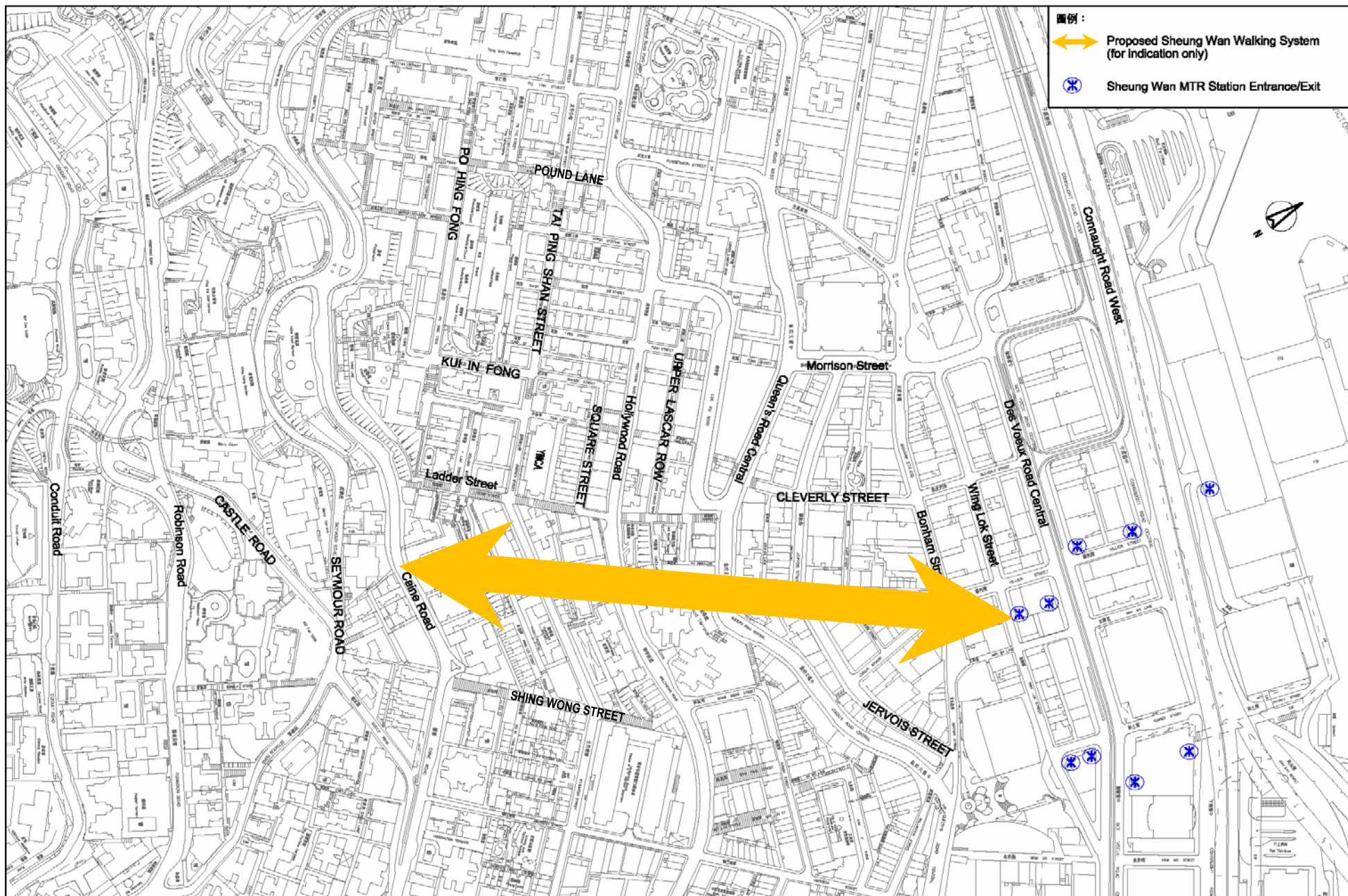

**Appendix B1 : General Layout Plan of Proposed Sheung Wan Walkway System**







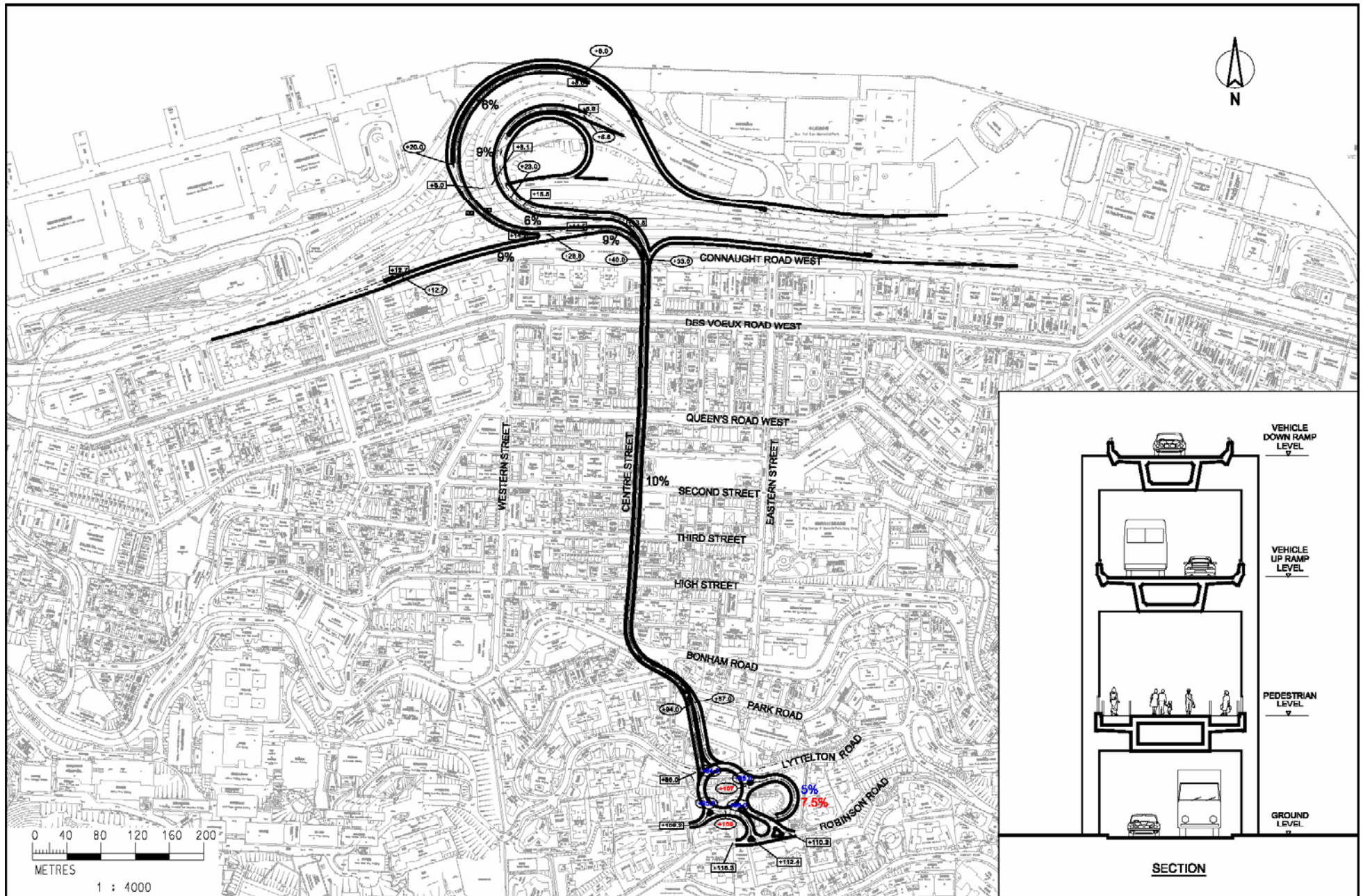

**Appendix C : Schematic Alignment Layout for the Conceived Highway Infrastructure along Centre Street**



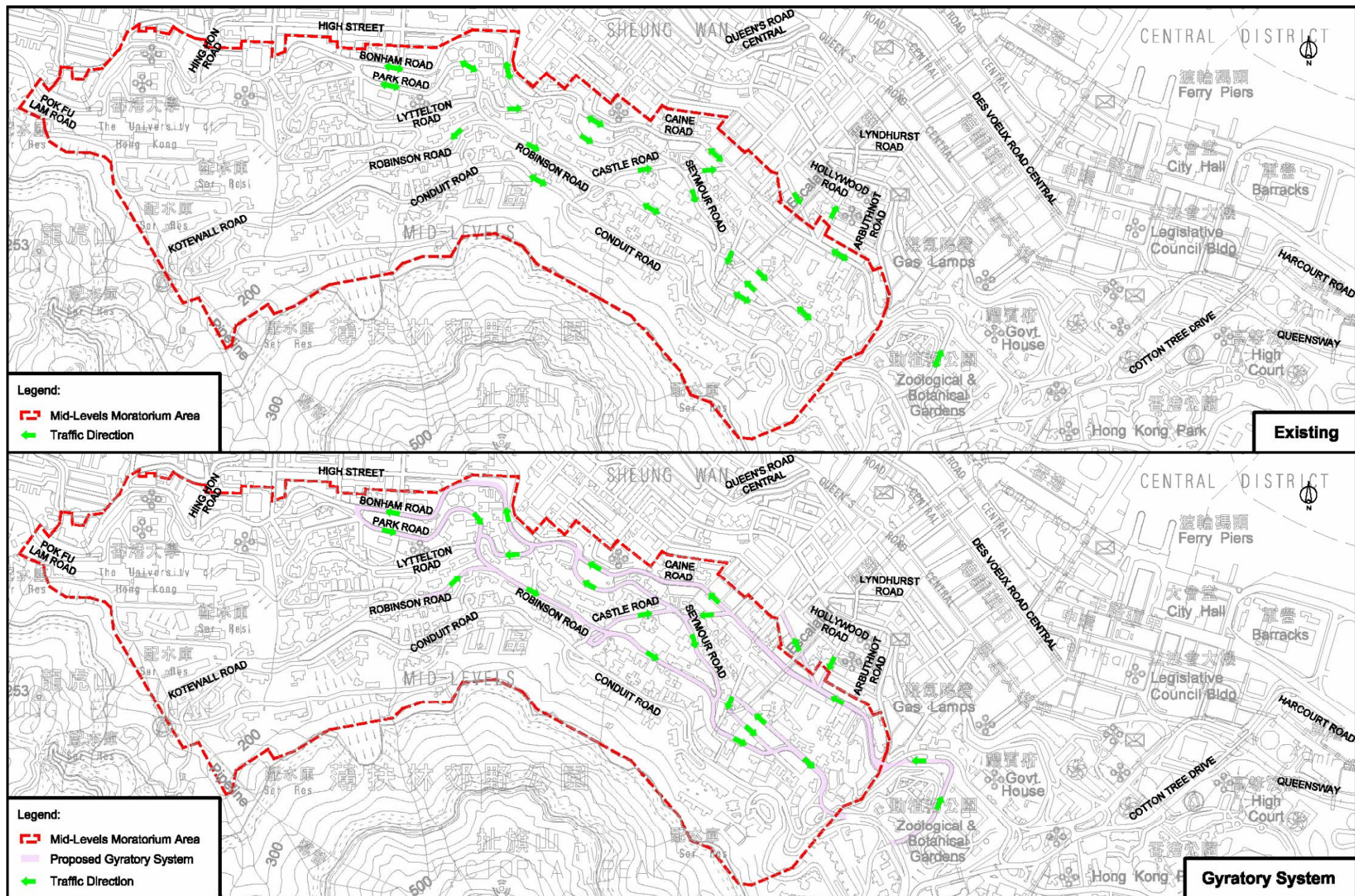

Appendix D : Conceived Traffic Gyratory System